

PRODUCT SAFETY

Snap-on Incorporated

SAFETY RETROFIT

January 2011

PRODUCTS AFFECTED:

All Open Front 4-Post Lifts with 1" Threaded Cylinder Piston Rod Ends made by Wheeltronic / Snap-on Equipment and distributed under the following brands: John Bean, Hofmann, Wheeltronic, Hennessy Industries, American Tire Distributors and Accu Industries.

PART NAME & DESCRIPTION:

Automotive Lift used for General Service and Vehicle Alignment
Open Front 4-Post Lifts - 172" and/or 210" Wheelbase capabilities, with 24" wide runways.

HAZARD:

During raising or lowering of the lift, the threaded cylinder piston rod end may fracture, causing the lift to suddenly drop. This may cause serious personal injury or death.

ACTIONS:

Snap-on Equipment is voluntarily replacing hydraulic cylinders used in production of open front 4-Post lifts manufactured from 1997 to 2008.

QUESTIONS:

If you have questions on this advisory or need assistance contact: Customer Service at (800) 362-4619.

PRODUCT SAFETY

Snap-on Incorporated

PART NUMBER(s):

Brand	Models - includes models that end "-M"
John Bean	44212OQ, 44212OQE, 44214Q, 44214QE
Hofmann Industries	FPOA12172, FPOA12210, FPOA14172, FPOA14210
Wheeltronic	12407AF, 12407AFX, 12407CW, 12407XCW, 14407AF, 14407AFX, 14407CW, 14407XCW
Hennessy Industries	S412OSA___, S412OSS___, S412OXA___, S412OXS___, S414OA___, S414OSA___, S412OXA___
American Tire Distributors (ATD) previously operating as Heafner Tire	WH-12407___, WH-120EAL, WH-120EALH, WH-812407AFX, WH-120EXTCW, WH-120EXTCWH, WH-12FD, WH-12Q210
Accu Industries	AC12407AF, AC12407AFM, AC12407AFXM, AC12407XT
Snap-on	EELR121A, EELR121AEXT, EELR121EXTP, EELR121APKG

Please inspect the Model Number/Serial Number tag on the lift (See Fig. 1 on the next page).

Do not stand on or under the lift unless lift platform is properly seated on the lift column safety locks. Operators and bystanders need to be clear of the lift during raising and lowering.

Operators must continue maintenance and periodic lift inspections as per product manuals, product advisories and ANSI/ALI ALOIM, ANSI/ALI ALIS standards for automotive lifts.

Please affix the enclosed warning sticker to the lift column in the location identified in Figure 1.

If your lift model has been identified by this Product Safety Retrofit and was manufactured prior to January 1st, 2009, Snap-on Equipment will be contacting you to schedule a cylinder replacement.

QUESTIONS:

If you have questions on this advisory or need assistance contact: Customer Service at (800) 362-4619.

PRODUCT SAFETY

Either of these Serial Number / Model Number tags may have been applied to your lift. Either tag would be located in an area on the side of the drive runway near the turn plate cutout as shown in figure 1.

Tag 1 shown below used on older lifts.

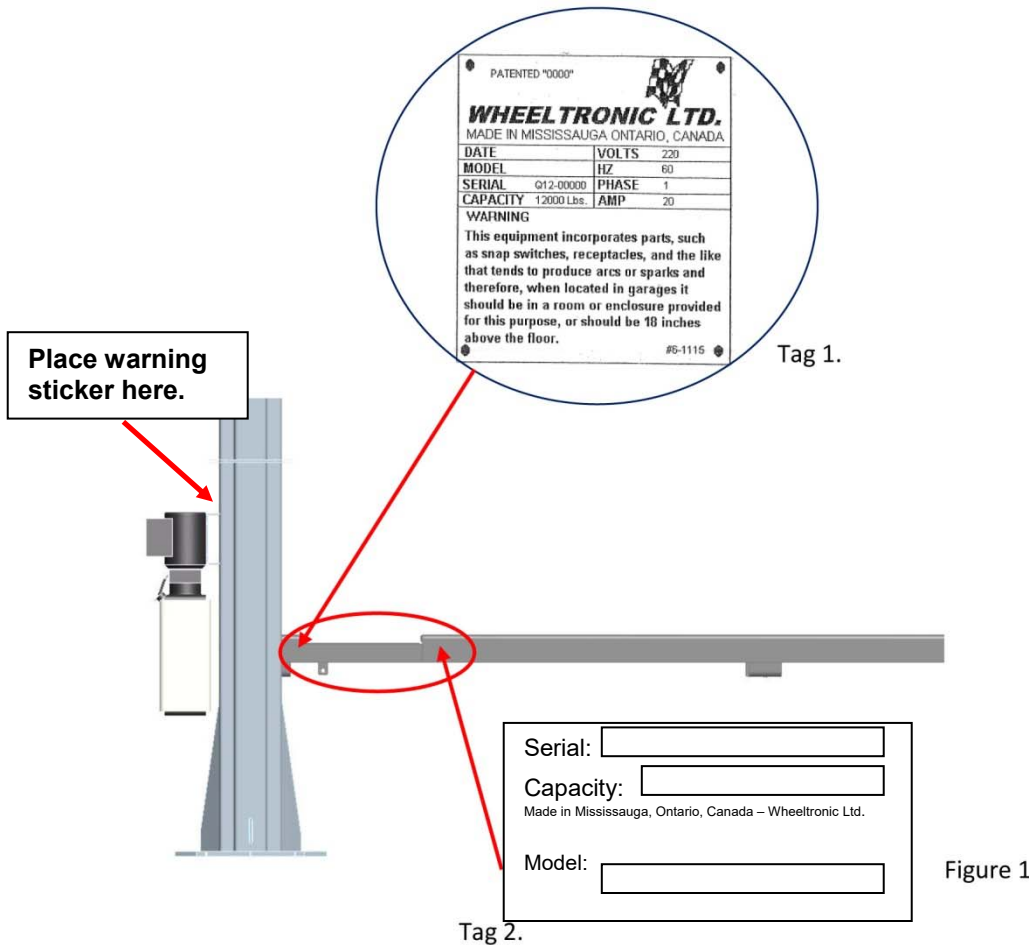

Tag 2 shown above used on more current lifts, date of manufacture was included in the serial number code, used separate, additional tags for voltage requirements and WARNING.

QUESTIONS:

If you have questions on this advisory or need assistance contact: Customer Service at (800) 362-4619.